

# SPIN-ON FILTERS

- FLOWS TO 60 GPM
- PRESSURES TO 150 psi
- STANDARD CAN THREADS
- DIE-CAST ALUMINUM HEADS

These are industry-standard filters; the replacement elements will fit the heads of other major manufacturers (and vice versa). The smaller model FEF-30 cans will interchange with those of U.S. manufacturers, and the larger Model FEF-51 cans will interchange with those of U.S. and some European suppliers.

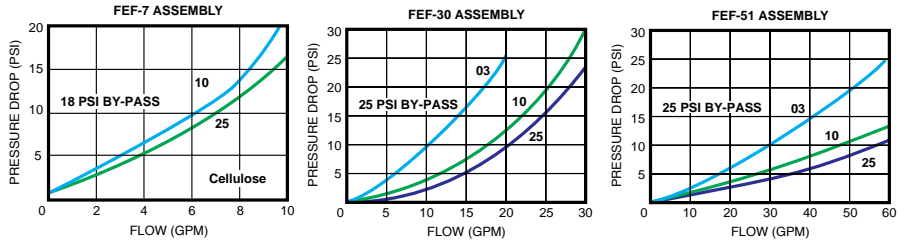

Typical pressure drop through clean filter assembly with oil viscosity of 150 SUS

## HOW TO ORDER COMPLETE FILTERS

Select the desired specifications from the ordering table and build an ordering code number, as shown in this sample:

**FEF - 30 - 12 - 10 - RV25**  
**STYLE - SIZE - PORT - ELEMENT - VALVE**

STYLE	SIZE	PORTS	ELEMENT	BYPASS VALVE	
FEF	7	04 (1/4 NPT)	03 (3 micron)* 10 (10 micron) 25 (25 micron)	RV-25 (25 PSI) size 30-51	
		06 (3/8 NPT)			
	30	12 (3/4 NPT)			RV-18 (18 PSI) size 7*
		12S (1-1/16-12 SAE)			
	51	20 (1-1/4 NPT)			0 no RV
		24 (1-1/2 NPT) 20S (1-5/8-12 SAE)			

\*Not available on FEF-7, bypass for FEF-7 is located inside element.

## HOW TO ORDER REPLACEMENT ELEMENTS

Select the desired specifications from the ordering table and build an ordering code number, as shown in this sample:

**FEE - 30 - 10**  
**STYLE - SIZE - ELEMENT**

STYLE	SIZE	ELEMENT	ELEMENT THREAD
FEE	7	*03 (3 micron)	(7) 3/4-16 UNF
	30	10 (10 micron)	(30) 1-12 UNF
	51	25 (25 micron)	(51) 1-1/2-16 UNF
		**100 (100 mesh)	

\*Not available on FEE 7. \*\*Available in FEE 30, 51 only

## HOW TO ORDER SPIN-ON HEADS

Select the desired specifications from the ordering table and build an ordering code number, as shown in this sample:

**FEH - 30 - 12 - RV25**  
**STYLE - SIZE - PORT - VALVE**

STYLE	SIZE	PORTS	BYPASS VALVE	
FEH	7	04 (1/4 NPT)	RV-25 (25 PSI) size 30-51	
		06 (3/8 NPT)		
	30	12 (3/4 NPT)		RV-18 (18 PSI) size 7*
		16 (1-1/16-12 SAE)		
	51	20 (1-1/4 NPT)		0 no RV
		24 (1-1/2 NPT) 20S (1-5/8-12 SAE)		

\*Bypass for FEH-7 is located inside element.

	FILTER MODEL		
	FEF-7	FEF-30	FEF-51
A	3.05	3.75	5.15
B	1.29	2.87	2.58
C	4.5	7.28	9.56
D	.5	.63	1.5
G	3.05	3.86	5.04
H	1.50	1.50	1.87
L	1/4-20	1/4-20	5/16-18
M	1.12	1.52	2.40
Weight	13 oz	1.75 lb	4.0 lb

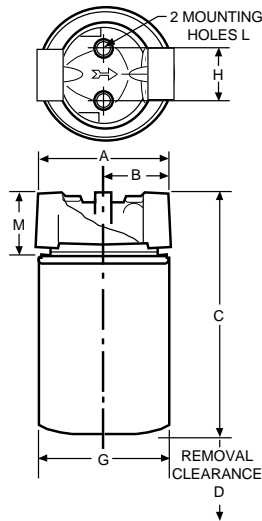

MODEL FEF-51  
 Element area 950 sq. in.  
 Flows up to 60 GPM (return)

MODEL FEF-7  
 Element area 117 sq. in.  
 Flows up to 7 GPM (return)



MODEL FEF-30  
 Element area 510 sq. in.  
 Flows up to 25 GPM (return)