

NSL NSL Technology Resources (s) Pte Ltd
No 280 Woodlands Industrial Park E5,
#09-11 Harvest @ Woodlands,
Singapore 757322
Tel : +65 67957477, 7747 Fax : +65 63162368
Email : sales@nsltechnology.com



R E P U B L I C
Blower Systems®

Republic Air Knife Systems

History of Republic

- Founded in 1962
- Primary business was custom sheet metal
- 1992 began distributing vacuum pumps
- 1994 began distributing centrifugal blower/air knives
- 1998 began distributing pd blowers
- 1999 began design of our own blower/air knives
- 2002 developed the Republic Regenerative Blower product line
- 2005 RB500 Introduced
- 2007 RB2000 Introduced
- 2009 Development of RB4000
- 2010 Tube Axial Fan Line Introduction
- 2012 Centrifugal High Efficiency Backward Incline Impeller

Republic Air Knife

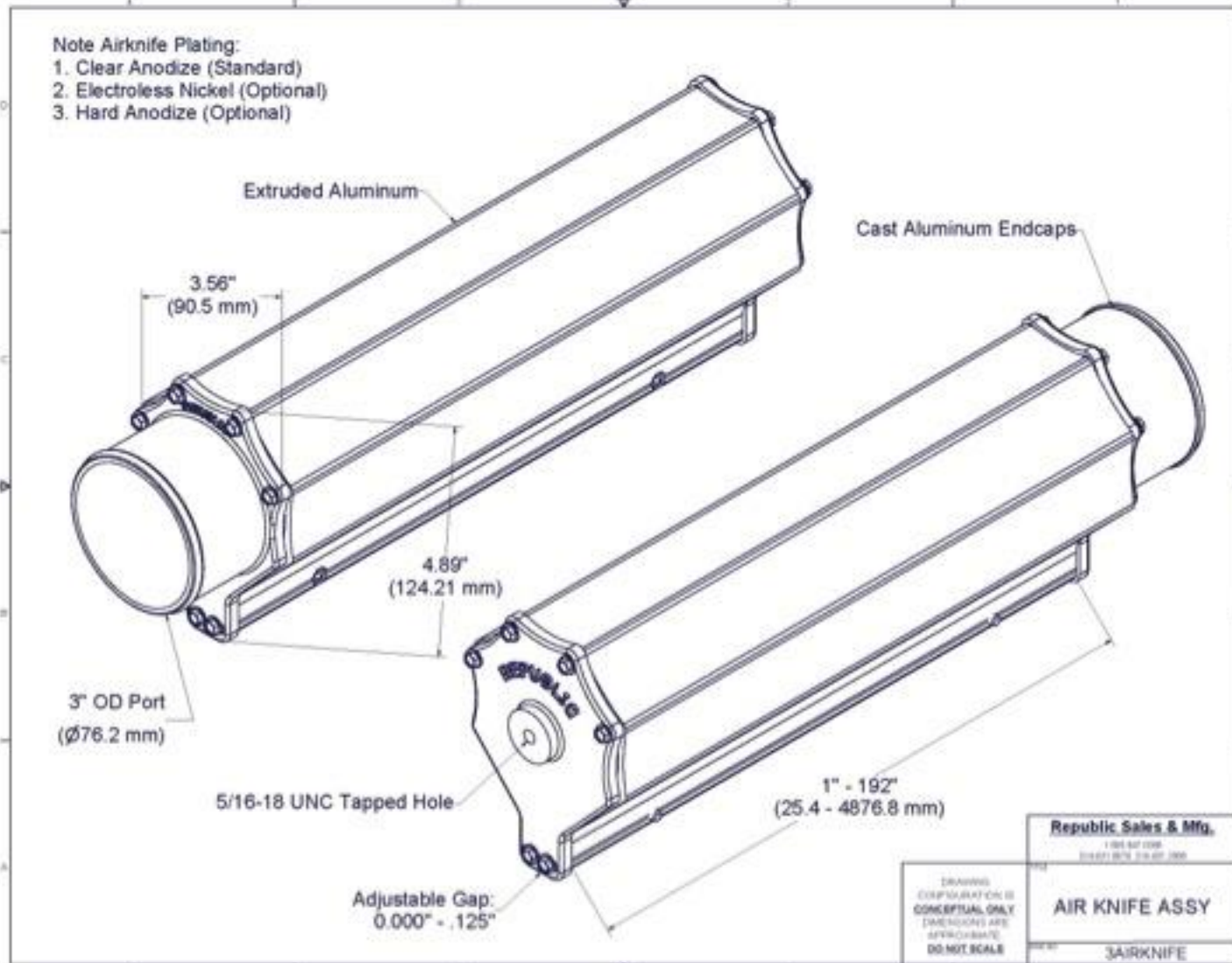

Not All Air Knives Are Equal



Round Tubular Air Knife

Low manufacturing cost but very low efficiencies.
Dissipates immediately, reduces air flow.

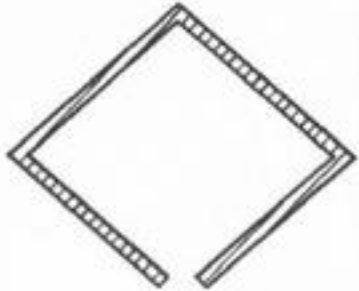

Square Tubular Air Knife

Higher internal losses but better exit efficiencies.
Creates turbulence

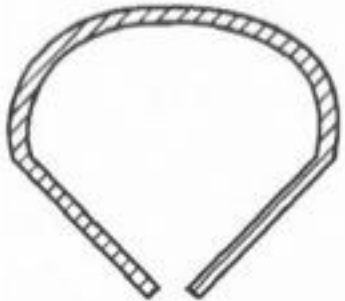

Tear Drop Air Knife

A viable design with high manufacturing costs.

Republic Air Knives



- The air exits as an uninterrupted continuous curtain with a totally controlled pattern.
- This stability guarantees minimal surrounding air excitation on the downstream leg and a narrow pattern on the upstream end.
- Overall air knife efficiencies $> 95\%$ are achieved.

Air Knife Types

- Materials Of Construction
 - Clear Anodized Aluminum



- Stainless Steel



Air Knife Types

Clear Anodized Aluminum

- Least Expensive Option
- Good for Most Industrial Applications
- Do Not Use Where Corrosive Chemicals are Present
- Usually Not Suitable When In Direct Contact with Food
- Normally Suitable When Drying “Sealed” Products like Cans, Bottles, Etc.
- **Available With 2” or 3” Inlets**



Air Knife Types

Stainless Steel









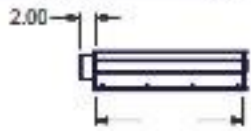

- 316 Stainless Steel Construction
- Good for Acid, Alkali, or Salty Applications
- Normally Required When Air Knife Comes In Contact With Food
- Much More Rugged In Most Applications But Most Expensive
- **Available with 2", 3" or 4" Inlets**

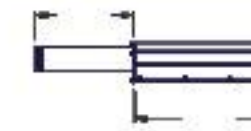

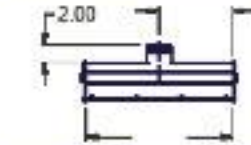
Air Knife Styles

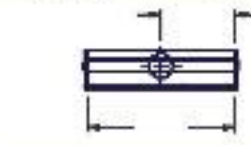
Air Knife Order Sheet

Material: Clear Anodize (CL) OD: 2" Gap _____
 Stainless Steel (SS) 3" Cust. Name _____
 Other _____ 4" Cust. P.O. _____

	Std Inlet <input type="checkbox"/>	
Example (310-4018CL-SI)		
	Std Ext Inlet <input type="checkbox"/>	
Example (310-4018CL-SEI-T2) Specify Length 12" Max		
	Top Mid Inlet <input type="checkbox"/>	
Example (310-4018CL-TMI)		
	Side Mid Inlet <input type="checkbox"/>	
Example (310-4018CL-SMI)		
	No Inlets <input type="checkbox"/>	
Example (310-4018CL-NI)		

Part Number Example 310-4216CL-SMI

312 - 2" Dia Inlet
 310 - 3" Dia Inlet
 314 - 4" Dia Inlet









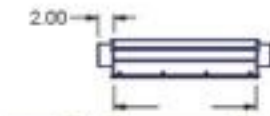

CL = Clear Anodize
 S = Stainless Steel

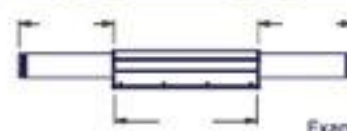
SMI = Side Middle Inlet

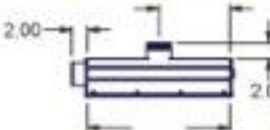
Air Knife Length (Max Length - 216")

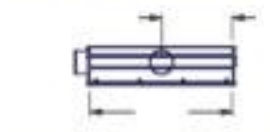
Air Knife Order Sheet

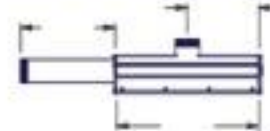
Material: Clear Anodize (CL) OD: 2" Gap _____
 Stainless Steel (SS) 3" Cust. Name _____
 Other _____ 4" Cust. P.O. _____

	Dual Inlet <input type="checkbox"/>	
Example (310-4018CL-DI)		
	Dual Ext Inlet <input type="checkbox"/>	
Example (310-4018CL-DEI-T2) Specify Length 12" Max		
	Dual Inlet with End & Top Mid Inlet <input type="checkbox"/>	
Example (310-4018CL-DIE&TMI)		
	Dual Inlet with End & Side Mid Inlet <input type="checkbox"/>	
Example (310-4018CL-DIE&SMI)		
	Dual Inlet with Ext End & Mid Top Inlet <input type="checkbox"/>	
Example (310-4018CL-DIE&TMI-T2) Specify Length 12" Max		

Part Number Example 310-4216CL-SMI

312 - 2" Dia Inlet
 310 - 3" Dia Inlet
 314 - 4" Dia Inlet

CL = Clear Anodize
 S = Stainless Steel

SMI = Side Middle Inlet

Air Knife Length (Max Length - 216")

Specialty Air Knives

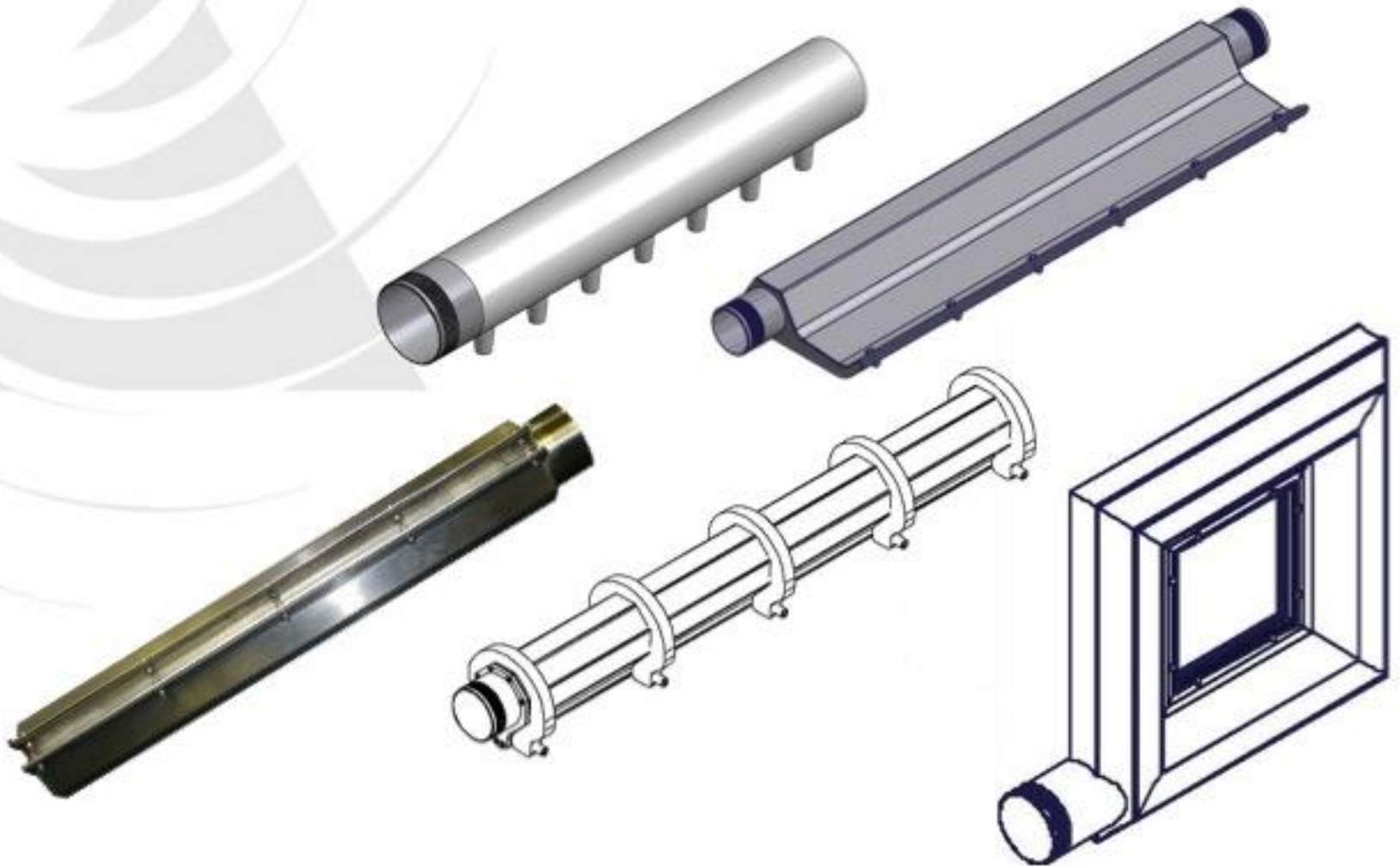

Advantages of Air Knife vs. Compressed Air

- Cleaner
- More effective/
better job
- Much less
expensive



Common Compressed Air Knives and Nozzles



Blow-Off Nozzles



Flat Jets or Air Comb Nozzles

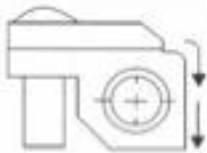

Compressed Air Knives

System Payback Analysis

Scale Removal / Blow Off

- Existing Compressed Air system vs. Republic Air Knife System
 - *This analysis is based on the following assumptions:*
 - Current system running at 100 psi
 - Plant running 24/7
 - Use of (16) - 1/8" nozzles over 36" long span
 - \$0.11 per kilowatt
 - It takes one (1) horse power to create 4 SCFM compressed air
 - 1 Hp = .746 kw



Existing System Energy Cost Per Week vs. Republic System

- **Compressed Air (16) 1/8" nozzles over 36" span**
 - (16) 1/8" nozzles at 100 psi =416 SCFM
 - 416 SCFM / 4 (industry standard assumption) =104 Hp to produce req. compressed air
 - 104 Hp X 168 Hrs / week (24/7) X .746 kw / Hp =13,034 kw / week
 - \$0.11 per kw X 13,034 kw / week = \$1,433.75 / week to operate
- **Republic Systems Cost (1-36" long Aluminum Air Knife / 7.5 Hp)**
 - 7.5 Hp X 168 Hrs/week X .746 kw / Hp =940 kw / week
 - \$.11 X 940 kw / week = \$103.40 / week to operate
- There is a \$1,330.35 savings per week with the Republic Air Knife System

15X more efficient to operate

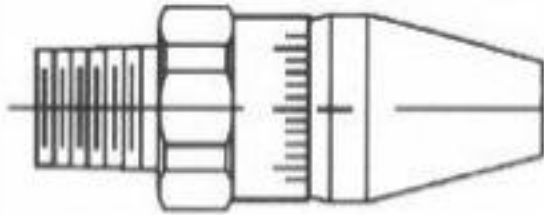

Flow of Compressed Air Through An Orifice

Flow of Compressed Air Through an Orifice
Diameter of Orifice in inches

Fraction	1/32	1/16	1/8	1/4	3/8	1/2	5/8	3/4	7/8	1	1-1/8	1-1/2	2
Area in ²	0.0008	0.0021	0.0123	0.0491	0.1104	0.1963	0.3068	0.4418	0.6013	0.7854	1.2272	1.7671	3.1416
PSIG	Orifice Flow in SCFM based on ambient conditions of 14.7 PSIA and 68°F												
1	0.11	0.45	1.8	7.2	16.2	29	45	65	89	115	160	239	460
2	0.16	0.64	2.5	10.2	22.9	41	64	92	125	163	254	366	661
3	0.19	0.78	3.1	12.5	28.0	50	78	112	153	199	311	448	797
4	0.22	0.90	3.6	14.4	32.4	58	90	129	176	230	350	518	920
5	0.25	1.00	4.0	16.1	36.2	64	100	145	197	257	402	579	1029
6	0.28	1.10	4.4	17.6	39.6	70	110	159	218	282	440	634	1127
7	0.30	1.19	4.8	19.0	42.8	76	119	171	233	304	476	685	1216
8	0.32	1.27	5.1	20.3	45.8	81	127	183	249	325	506	732	1302
9	0.34	1.35	5.4	21.6	48.5	86	135	194	264	345	539	777	1391
10	0.36	1.42	5.7	22.7	51.2	91	142	205	279	364	568	819	1455
11	0.37	1.49	6.0	23.8	53.7	95	149	215	292	382	596	859	1526
12	0.39	1.56	6.2	24.9	56.0	100	156	224	305	400	623	897	1594
13	0.41	1.62	6.5	25.9	58.3	104	162	233	318	415	648	933	1659
14	0.42	1.68	6.7	26.9	60.5	108	168	242	330	430	673	969	1722
15	0.44	1.74	7.0	27.8	62.7	111	174	251	341	446	699	1003	1782
17	0.45	1.80	7.2	28.8	64.7	115	180	259	352	460	719	1036	1840
19	0.48	1.91	7.6	30.6	68.6	122	191	275	374	489	764	1100	1956
21	0.51	2.02	8.1	32.4	72.9	130	202	291	397	518	810	1168	2072
23	0.53	2.14	8.5	34.2	76.9	137	214	308	419	547	855	1233	2188
25	0.55	2.25	9.0	36.0	81.0	144	225	324	441	576	900	1294	2305
27	0.59	2.36	9.5	37.8	85.1	151	236	340	463	605	946	1362	2421
29	0.62	2.48	9.9	39.6	89.2	158	248	357	486	634	991	1427	2537
31	0.65	2.59	10.4	41.5	93.3	166	259	373	508	663	1036	1492	2653
33	0.66	2.70	10.8	43.3	97.3	173	270	389	530	692	1082	1558	2769
35	0.70	2.82	11.3	45.1	101.4	180	282	406	552	721	1127	1623	2885
40	0.78	3.10	12.4	49.6	111.6	198	310	447	608	794	1240	1786	3175
45	0.85	3.38	13.5	54.1	121.8	217	338	487	663	866	1354	1949	3466
50	0.92	3.67	14.7	58.7	132.0	235	367	528	719	939	1467	2113	3756
55	0.99	3.95	15.8	63.2	142.2	253	395	569	774	1011	1580	2276	4046
60	1.06	4.23	16.9	67.8	152.4	271	423	610	830	1084	1694	2439	4336
65	1.13	4.52	18.1	72.3	162.6	289	452	651	886	1157	1807	2602	4626
70	1.20	4.80	19.2	76.8	172.9	307	480	692	941	1229	1921	2766	4917
75	1.27	5.08	20.3	81.4	183.1	325	508	732	997	1302	2034	2929	5207
80	1.34	5.37	21.5	85.9	193.3	344	537	773	1052	1374	2147	3092	5497
85	1.41	5.65	22.6	90.4	203.5	362	565	814	1108	1447	2261	3255	5787
90	1.48	5.94	23.7	95.0	213.7	380	594	855	1163	1519	2374	3419	6078
95	1.55	6.22	24.9	99.5	223.9	398	622	895	1219	1592	2487	3582	6368
100	1.63	6.50	26.0	104.0	234.1	416	650	936	1274	1665	2601	3745	6658
105	1.70	6.79	27.1	108.6	244.3	434	679	977	1330	1737	2714	3908	6948
110	1.77	7.07	28.3	113.1	254.5	452	707	1018	1386	1810	2828	4072	7239
115	1.84	7.35	29.4	117.6	264.7	471	735	1059	1441	1882	2941	4235	7529
120	1.91	7.64	30.5	122.2	274.9	489	764	1100	1497	1955	3054	4398	7819
125	1.98	7.92	31.7	126.7	285.1	507	792	1140	1552	2027	3168	4562	8109
130	2.05	8.20	32.8	131.2	295.3	525	820	1181	1608	2100	3281	4725	8400

System Payback

- Republic System Cost (1-36" air knife w/7.5 hp Blower)
- *RB500-7.5Hp, 36" A/K, Butterfly Valve, A/K Brackets, Sleeve, 90 degree elbow, flex hose*
=\$4,604.28
- \$4,604.28 / \$1330.35 (savings per week over compressed air/week)
=3.5 week breakeven

*** 3.5 Weeks For Complete Republic Blower System Pay-Back Over Compressed Air**

**This comparison does not take into account any compressor maintenance costs. It is only based on the electrical consumption between what you are currently using and what you would use with a Republic Air Knife System.*

Typical Applications

- Bottles & Cans
- Conveyor Belt
- Crate Drying
- Parts Drying
- Cheese Drying
- Bakery
- Candy and Confectionary
- Stampings
- Hanging Parts – Powder Coating
- Tile Drying
- Tires, Rubber Strip, and Belting
- Pipe and Tubing
- Wire and Cable
- Printed Circuit Board Drying
- Battery Manufacturing
- Plating and Metal Finishing
- Metal Sheet Drying/De-Oiling
- Metal and Plastic Extrusions
- Vacuum Hold Down – CNC
- Wood Working Industry

Drying Challenges

- Cans
 - Rust
 - Stress Corrosion
 - Printing Issues
- Labeling
- Keep Packaging Dry
- Eliminate Water Spots



[http://
www.youtube.
com/watch?
v=pBMGepPh5
U0](http://www.youtube.com/watch?v=pBMGepPh5U0)

Drying Challenges

■ Bottles

- Hot Melt Labeling on Cold Fill
- PVC Sleeve Labels
- Pressure Sensitive Labels
- Ink Jet Printing
- Keep Packaging Dry
- Eliminate Water Spots



Drying Challenges

- Conveyor Belt
 - Debris removal (dust, powder, crumbs, etc.)
 - Liquid removal after washing
 - Remove liquid in one location rather than “dragging” it around the plant
- Crate Drying
 - Dry crates after washing
 - Keep liquid off of product to avoid water damage
 - Reduce dragging water around the plant

Drying Challenges

[http://
Parts Drying
Video](http://PartsDryingVideo)

- **Parts Drying / Stampings**
 - Blow moisture or oil off of parts
 - Reduce energy consumption if customer is currently using an oven
 - Prepare parts for packaging, painting, plating or sale
- **Bakery / Confectionary**
 - Open blowing – to de-pan the buns from the pans
 - Belt cleaning and drying
 - Pan Cleaning - Debris blow off (flour out of pans, etc.)
 - Blow off excess ingredients (flour, sugar, salt, grain, etc.)
 - Prevent dough from falling between rollers

Drying Challenges

- Hanging Parts Drying
 - Parts need blow off prior to powder coating
 - Air nozzle Knife works well here
 - Use nozzles focused on contoured areas
 - Reduces oven temperature



Drying Challenges



Drying Challenges

■ Tile Drying

- Drying the tile after it is cut with a water jet cutter
- Drying tiles prior to packaging
- Tile cooling prior to ink jet printing
- Debris removal prior to packaging

<http://Tile Drying Video>

Drying Challenges

- Tire, Rubber Strip, & Belting
 - Drying the sidewall when it comes out of the extruder
 - Drying tires prior to packaging
- Pipe & Tubing
 - Remove excess water before bar-coding
 - Remove excess water after running through the dip bath
 - Corrosion prevention
 - “Picture frame” air knife ideal here

Drying Challenges

- Printed Circuit Board Drying
 - Drying boards after being soldered
 - Drying boards before being “populated”
- Battery Manufacturing
 - Drying after manufacturing and filling
 - Removing excess acid
 - Use 316 Stainless Steel Air Knives



Drying Challenges

- Vacuum Hold Down – CNC Tables
 - Pulls vacuum through a series of holes on the tables
 - High air volume – ideal for fabric and textile industry

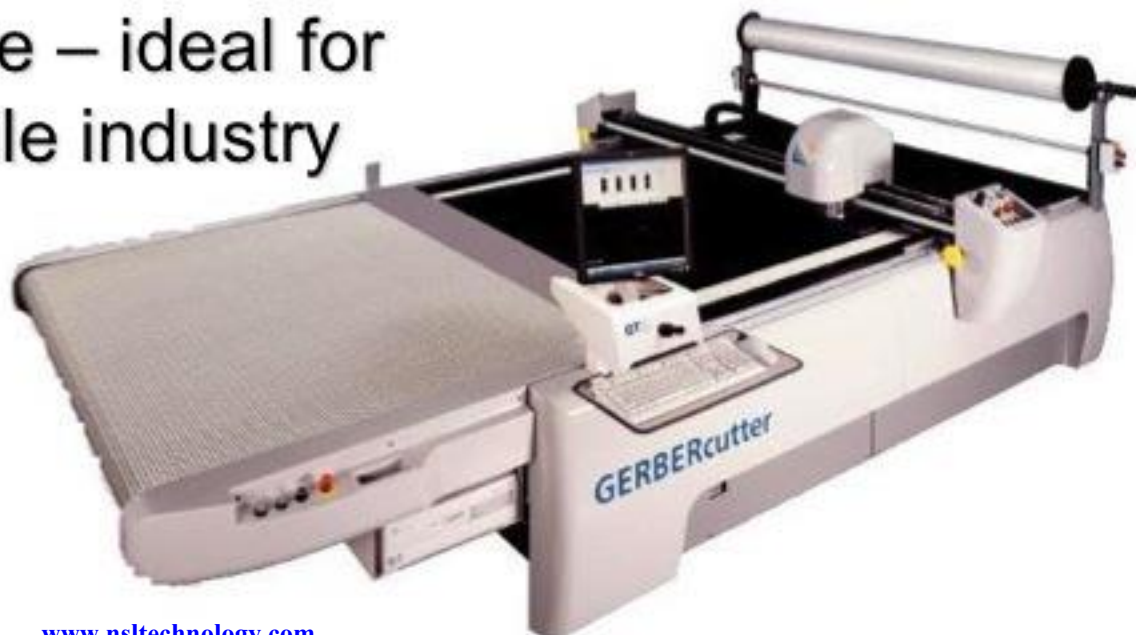

Drying Challenges

- Wood Working Industry
 - Blowing off boards after being sanded
 - Cleaner air, no oil
 - Huge cost savings
 - Air knife at the entry and exit of sander
 - Small to large shops will have a use for this

Standard Support Brackets

- Standard brackets
- One set needed per air knife
- 304 Stainless Steel Construction
- Both pieces included in set
- 2" bracket=312-9000
- 3" bracket=310-9000
- 4" bracket=314-9000

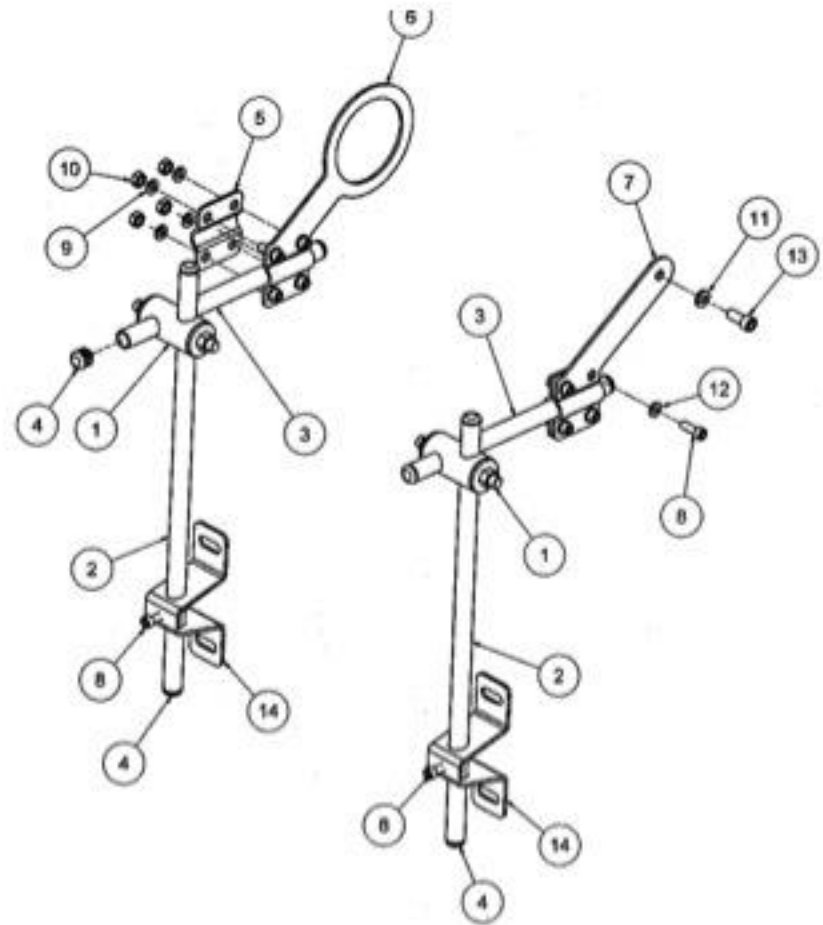

Inlet Side Brackets

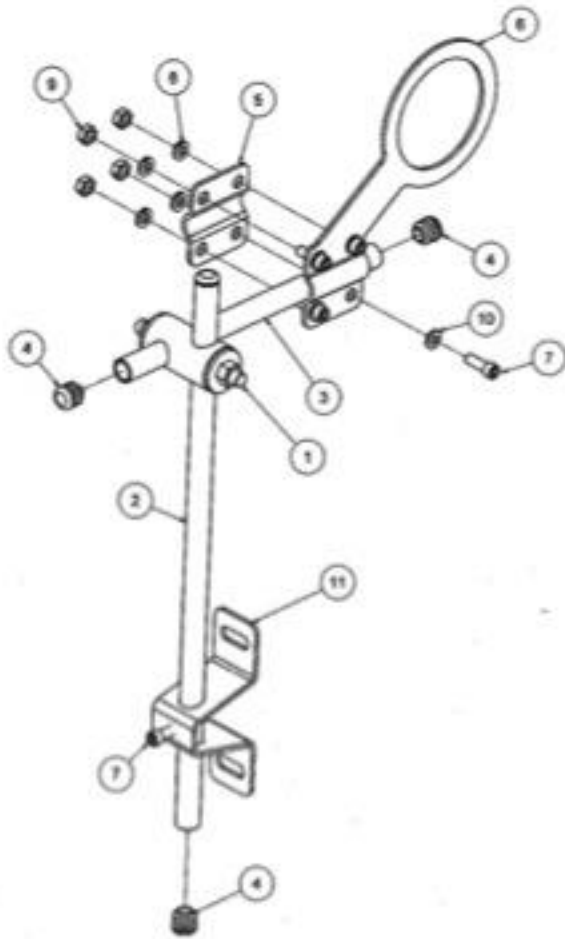

- Used to support dual inlet air knives or nozzles
- 2 needed for dual inlet air knife
- 2" inlet = 312-9001
- 3" bracket=310-9001
- 4" bracket=314-9001

Closed End Bracket

- Used to support middle inlet air knives
- 2 required per air knife
- 2" inlet = 312-9004
- 3" bracket=310-9004
- 4" bracket=314-9004

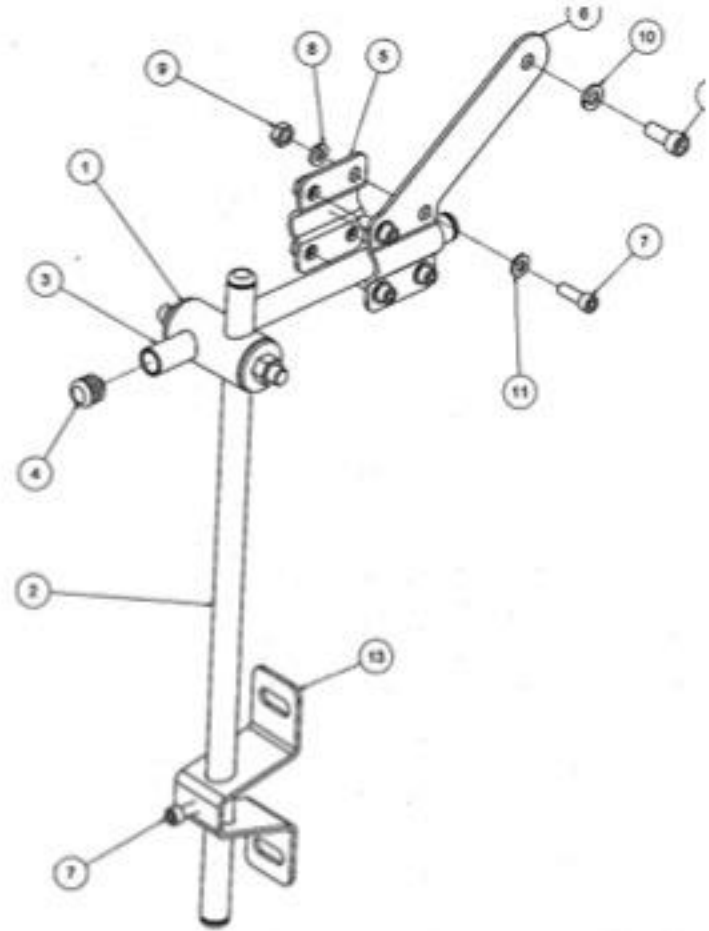

Bracket With Knobs

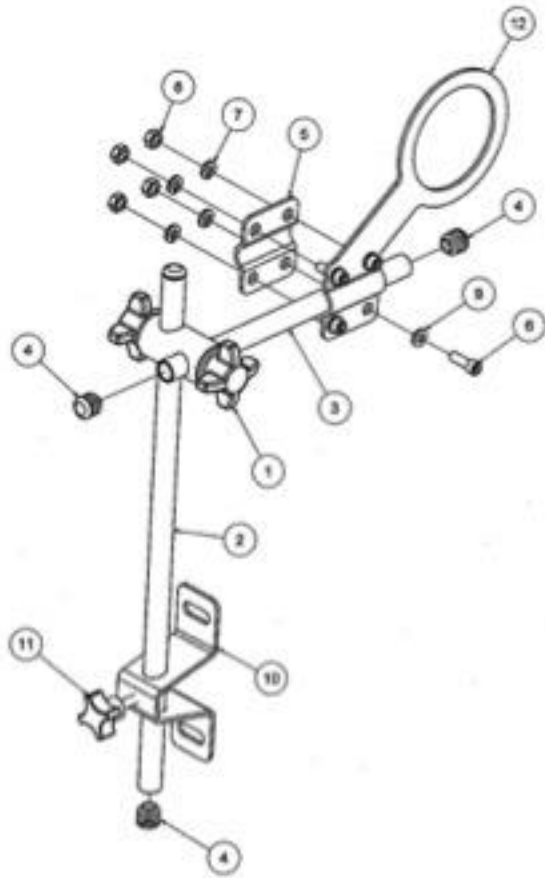

- Brackets with hand adjustment knobs
- Standard brackets can be tightened better with less problems in the field

Blower Options

- Water Cooling – Allows Intake Temperature to 350 Degrees F
- Inlet and Outlet Flanges
- Hard Anodize Blower
- Metric Back Plate
- Low or High Profile Enclosures
- Stainless Steel Enclosures
- Motor available in premium efficiency, wash-down duty, and explosion-proof



Blower Silencer/dB Levels

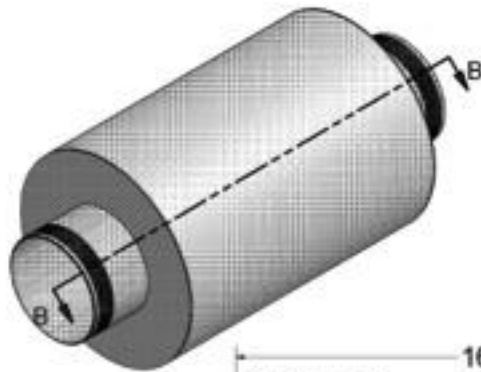

- RB1200 Blower no Silencer & no Enclosure = 92-96 dB**
- RB1200 Blower w/ Silencer & no Enclosure = 88-90 dB**
- RB1200 Blower no Silencer & w/ Enclosure = 80-82 dB**
- RB1200 Blower w/ Silencer & Enclosure = 74-78 dB**

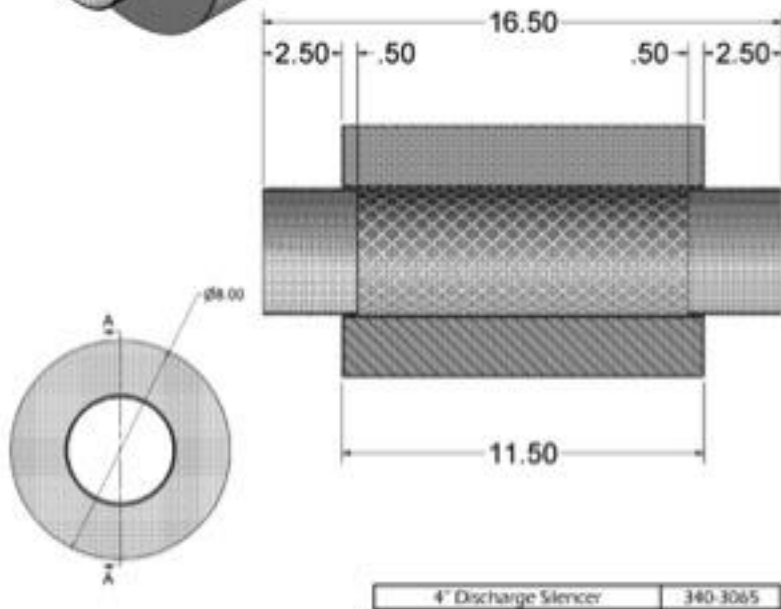

- 2" Connection 340-3075**
- 3" Connection 340-3062**
- 4" Connection 340-3065**
- 5" Connection 340-3068**
- 6" Connection 340-3070**

Blower Comparison Chart

Features	RBS	Sonic	ITW Paxton	Advantage
Ceramic Hybrid Bearings	Yes	No	No	Ceramic balls always run cooler than steel balls prolonging lubricant life. Vibration levels run 2-7 times lower than with same size steel bearings. Service life of ceramic balls is 2 to 5 times greater than conventional steel balls. Maximum running speed is 40% greater than steel ball bearings. Steel balls will cold weld to steel rings even under normal load and lubricant conditions. This reduces lubricant and bearing life. For more information on Ceramic Bearings see http://www.nsk.com Reduced maintenance expense.
16 Groove Micro-V Belt	Yes	Yes	Yes	Wider belt contacts more of the pulley surfaces resulting in less slippage, lower heat, and longer belt life. Reduced maintenance expense.
Steel Bearing Housing Standard (Electroless Nickel Plated)	Yes	No	Yes	Higher tensile strength than aluminum giving better stability and lower vibration than aluminum bearing bore. Lower coefficient of thermal expansion giving bearing a better fit in bore when blower is hot. Longer blower life.
Stainless Steel Blower Pulley	Yes	Yes	No	More wear and corrosion resistant than plated metal. Reduced maintenance expense.
Steel Motor Pulley (Electroless Nickel Plated)	Yes	No	No	Three-four times the weight of aluminum pulley causing slower startup speeds. Reduced wear on blowerdrive assembly. Not damaged when belt slips. Lower maintenance expense.
Cooling Fins on Bearing Housing	Yes	No	Yes	Reduces operating temperature of bearing housing. Longer bearing and lubrication life. Longer blower life.
PTFE Shaft Seal on Both Sides of Bearing Assembly	Yes	No	No	Contaminants are the #1 cause of blower failure. Republic's proprietary seal design reduces blower failure over the competition. Longer blower life.
High Performance Impeller Design	Yes	No	Yes	The Republic Blower moves more air per rotation than the competition. This translates to lower operation speeds with equal performance and significantly increased blower life.
Largest Tension Pulley	Yes	No	No	Slower tension pulley speed greatly increases bearing life. Lower maintenance.
Two Bearings on Tension Pulley with Seals to Stop Contaminants	Yes	No	No	Longer life than the competition. Lower maintenance expense.



Blower Comparison Chart

JetAir Centrifugal Blowers	Republic Centrifugal Blowers
<ul style="list-style-type: none"> • Requires a Variable Speed Drive adding a considerable amount to the price 	<ul style="list-style-type: none"> • Variable Speed Drive not required, but is available - a savings of \$2,500 or more per blower
<ul style="list-style-type: none"> • Very noisy, therefore usually requires an enclosure 	<ul style="list-style-type: none"> • Enclosures are not necessary in many applications but are available in needed
<ul style="list-style-type: none"> • Expensive enclosures 	<ul style="list-style-type: none"> • Because of in-house sheet metal manufacturing capabilities, our enclosures are approximately \$2,000 less per enclosure
<ul style="list-style-type: none"> • The blower and motor are integrated as one unit, therefore if the blower fails, the entire unit must be repaired/replaced 	<ul style="list-style-type: none"> • The blower and motor are separated by a belt acting as a buffer, keeping the blower cooler and less likely to fail. If blower fails, Republic offers a bearing cartridge at a small price compared to replacing the entire blower unit.
<ul style="list-style-type: none"> • Repairs and replacements must be sent to the factory 	<ul style="list-style-type: none"> • The separate bearing housing cartridge can be replaced by end user in 15 minutes or less
<ul style="list-style-type: none"> • Manufactured in Europe but distributed in USA, creating long lead times 	<ul style="list-style-type: none"> • Manufactured and distributed from the USA for shorter lead times
<ul style="list-style-type: none"> • 3 blowers available 	<ul style="list-style-type: none"> • 5 blowers available with 1 in development allowing the customer to only pay for the blower that best fits the application as opposed to the one-size-fits-all approach
<ul style="list-style-type: none"> • Less experience - founded in 2003 	<ul style="list-style-type: none"> • More experience - founded in 1962
<ul style="list-style-type: none"> • Small company with less resources 	<ul style="list-style-type: none"> • Medium-sized company with more R&D and customer service resources, but still small enough to act efficiently

JetAir claims to be more efficient and powerful than Republic. The adjacent graph shows otherwise.

*Data obtained from JetAir website and Republic Blower Systems website.

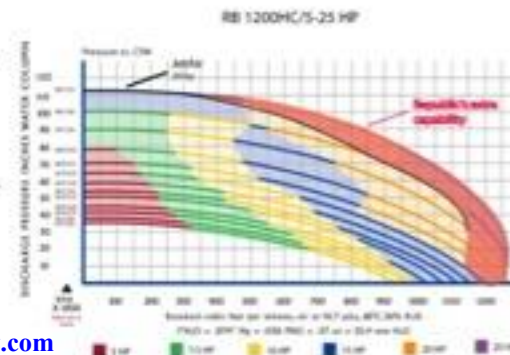

RB500/RB800/RB4000 – Self Tensioning Belt



Why Choose Republic?

- Field Replaceable Bearing Cartridge

- ¼ price of new blower
- We use Ceramic Hybrid Bearings
 - Life – 2 to 5 times longer than steel
- PTFE shaft seals used on each side of assembly
 - Contaminants are the #1 cause of blower failure
 - Secondary mechanical seals – second barrier
- Bearing housing cooling fins
 - Reduces temp of bearing housing

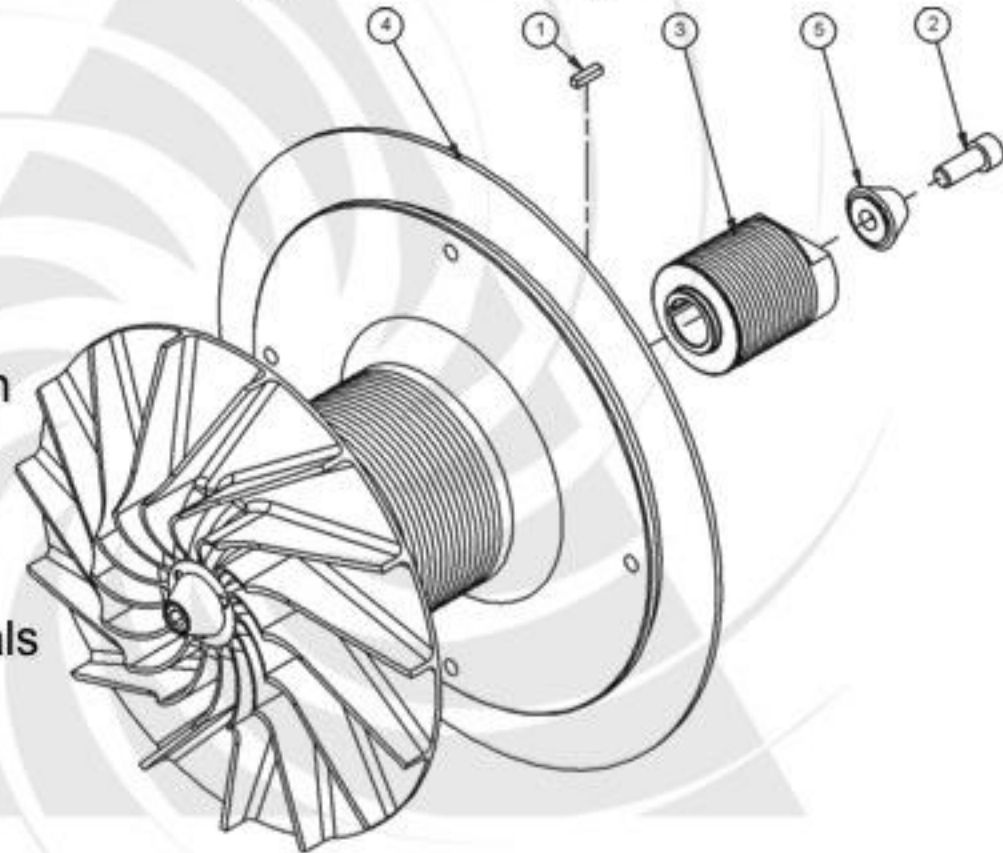

Centrifugal Blower Retro Kit (Everything Minus the Motor)

Ugrade your existing centrifugal blower system with a Republic Retro-Kit Blower. The Retro-Kit blower offers a NEW blower assembly with automatic belt tension and a 12-month warranty. Save money by using your existing motor and filter with a more efficient, more reliable Republic blower.

The Republic Retro-Kit Blower, available in 800 and 1200 models, is designed with advanced bearings and seals. Larger bearings also provide longer life for the automatic belt tension assembly. Republic blowers disassemble easily for cleaning and part replacement.

Minimize downtime by upgrading to a Republic Retro-Kit Blower...



... the blower designed to outperform any blower on the market.



Retro-Kit Blowers Include:

- ▲ Blower Head Complete
- ▲ Blower Backplate
- ▲ Automatic Belt Tensioner
- ▲ Drive Assembly Including:
 - Motor Pulley
 - Blower Pulley
 - Belt
- ▲ Belt Guard
- ▲ Motor Drive Bushing
- ▲ Motor Mount with Vibration Isolators

Advantages:

- ▲ Cleanability
- ▲ Ceramic Hybrid Bearings
- ▲ Larger Belt Tensioner for Lower RPM's
- ▲ Dynamically Balanced Impeller, Bearing Carrier and Pulley Assembly.
- ▲ Dual Bearings in Belt Tensioner for Longer Life
- ▲ Stainless Steel Blower Pulley
- ▲ 16 Groove Micro-V Belt Drive
- ▲ Fully Rotatable Blower Head Cover
- ▲ 1 Year Warranty
- ▲ Field Serviceable



Upgrade to The Republic Centrifugal Blower and receive a core trade in credit for your old blower. Please contact Republic Blower Systems for details.

*Your Complete Supplier
for Air Knife and
Airwipe Drying Systems.*

Blower Stands

- 304 stainless steel finish
- Leveling pads with mounting holes
- Pre-punched holes for mounting blowers
- More models available in distributor manual

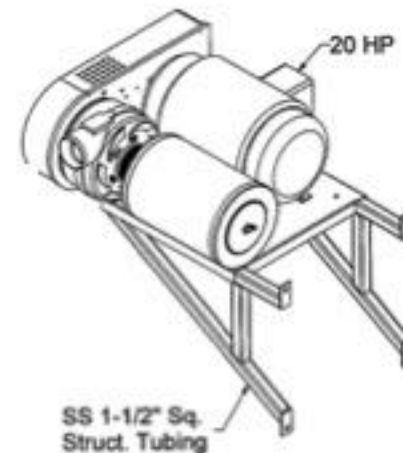
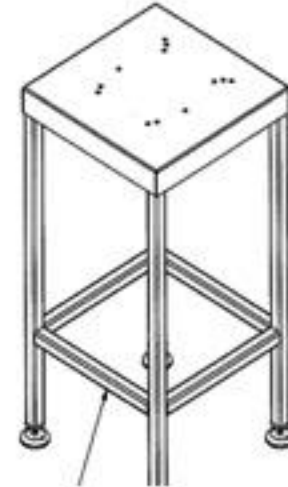

Blower / Motor Enclosures

- High Profile Enclosure
 - Internal wire mesh pre-filter
 - Magna helic filter change gauge
 - Provides the blower protection from water and contaminants
 - Significant Noise reduction
- Low Profile Enclosure
 - Same as above. Height is lower.

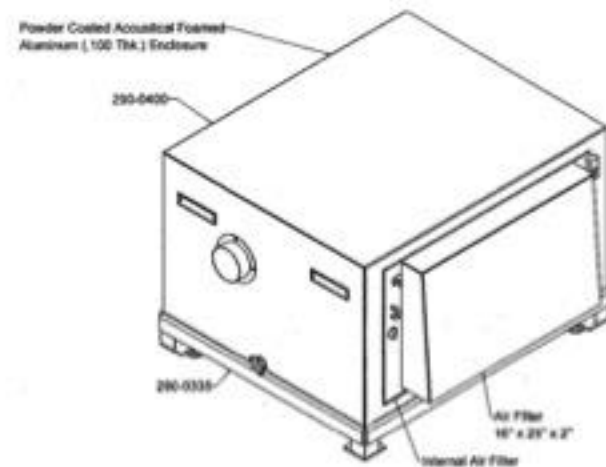
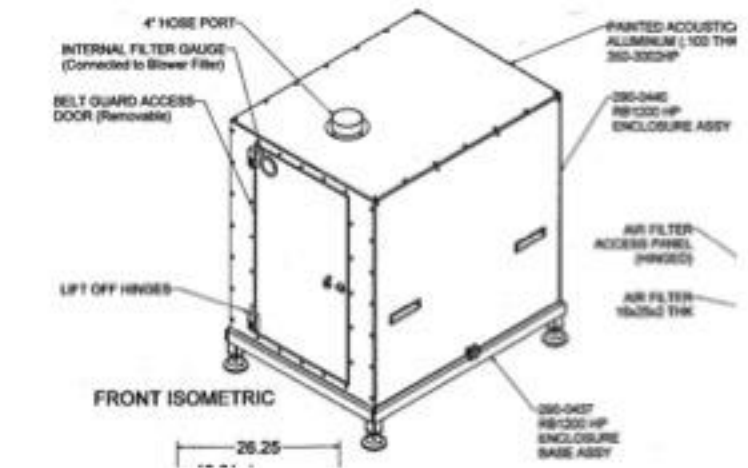

Air Knife Enclosures

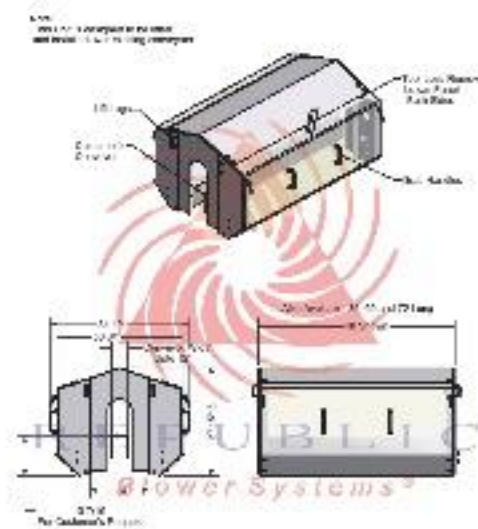

Base Model

Note: This Unit is designed to be filled and installed over existing conveyor.

Part No.	Description	QTY	Material
10001	Front Panel	1	304 SS
10002	Top Cover	1	304 SS
10003	Acoustic Foam Enclosure	1	Acoustic Foam
10004	Removable Top	1	304 SS
10005	Adjustable Feet	4	304 SS
10006	Lock Handles	2	304 SS
10007	Adjustable Leveling Feet	4	304 SS
10008	Removable Front	1	304 SS
10009	Pneumatic Control Panel	1	304 SS
10010	Front Panel	1	304 SS
10011	Adjustable Feet	4	304 SS
10012	Lock Handles	2	304 SS
10013	Adjustable Leveling Feet	4	304 SS
10014	Removable Front	1	304 SS
10015	Pneumatic Control Panel	1	304 SS
10016	Front Panel	1	304 SS
10017	Adjustable Feet	4	304 SS
10018	Lock Handles	2	304 SS
10019	Adjustable Leveling Feet	4	304 SS
10020	Removable Front	1	304 SS
10021	Pneumatic Control Panel	1	304 SS
10022	Front Panel	1	304 SS
10023	Adjustable Feet	4	304 SS
10024	Lock Handles	2	304 SS
10025	Adjustable Leveling Feet	4	304 SS
10026	Removable Front	1	304 SS
10027	Pneumatic Control Panel	1	304 SS
10028	Front Panel	1	304 SS
10029	Adjustable Feet	4	304 SS
10030	Lock Handles	2	304 SS
10031	Adjustable Leveling Feet	4	304 SS
10032	Removable Front	1	304 SS
10033	Pneumatic Control Panel	1	304 SS
10034	Front Panel	1	304 SS
10035	Adjustable Feet	4	304 SS
10036	Lock Handles	2	304 SS
10037	Adjustable Leveling Feet	4	304 SS
10038	Removable Front	1	304 SS
10039	Pneumatic Control Panel	1	304 SS
10040	Front Panel	1	304 SS
10041	Adjustable Feet	4	304 SS
10042	Lock Handles	2	304 SS
10043	Adjustable Leveling Feet	4	304 SS
10044	Removable Front	1	304 SS
10045	Pneumatic Control Panel	1	304 SS
10046	Front Panel	1	304 SS
10047	Adjustable Feet	4	304 SS
10048	Lock Handles	2	304 SS
10049	Adjustable Leveling Feet	4	304 SS
10050	Removable Front	1	304 SS
10051	Pneumatic Control Panel	1	304 SS
10052	Front Panel	1	304 SS
10053	Adjustable Feet	4	304 SS
10054	Lock Handles	2	304 SS
10055	Adjustable Leveling Feet	4	304 SS
10056	Removable Front	1	304 SS
10057	Pneumatic Control Panel	1	304 SS
10058	Front Panel	1	304 SS
10059	Adjustable Feet	4	304 SS
10060	Lock Handles	2	304 SS
10061	Adjustable Leveling Feet	4	304 SS
10062	Removable Front	1	304 SS
10063	Pneumatic Control Panel	1	304 SS
10064	Front Panel	1	304 SS
10065	Adjustable Feet	4	304 SS
10066	Lock Handles	2	304 SS
10067	Adjustable Leveling Feet	4	304 SS
10068	Removable Front	1	304 SS
10069	Pneumatic Control Panel	1	304 SS
10070	Front Panel	1	304 SS
10071	Adjustable Feet	4	304 SS
10072	Lock Handles	2	304 SS
10073	Adjustable Leveling Feet	4	304 SS
10074	Removable Front	1	304 SS
10075	Pneumatic Control Panel	1	304 SS
10076	Front Panel	1	304 SS
10077	Adjustable Feet	4	304 SS
10078	Lock Handles	2	304 SS
10079	Adjustable Leveling Feet	4	304 SS
10080	Removable Front	1	304 SS
10081	Pneumatic Control Panel	1	304 SS
10082	Front Panel	1	304 SS
10083	Adjustable Feet	4	304 SS
10084	Lock Handles	2	304 SS
10085	Adjustable Leveling Feet	4	304 SS
10086	Removable Front	1	304 SS
10087	Pneumatic Control Panel	1	304 SS
10088	Front Panel	1	304 SS
10089	Adjustable Feet	4	304 SS
10090	Lock Handles	2	304 SS
10091	Adjustable Leveling Feet	4	304 SS
10092	Removable Front	1	304 SS
10093	Pneumatic Control Panel	1	304 SS
10094	Front Panel	1	304 SS
10095	Adjustable Feet	4	304 SS
10096	Lock Handles	2	304 SS
10097	Adjustable Leveling Feet	4	304 SS
10098	Removable Front	1	304 SS
10099	Pneumatic Control Panel	1	304 SS
10100	Front Panel	1	304 SS

Sample System Drawing

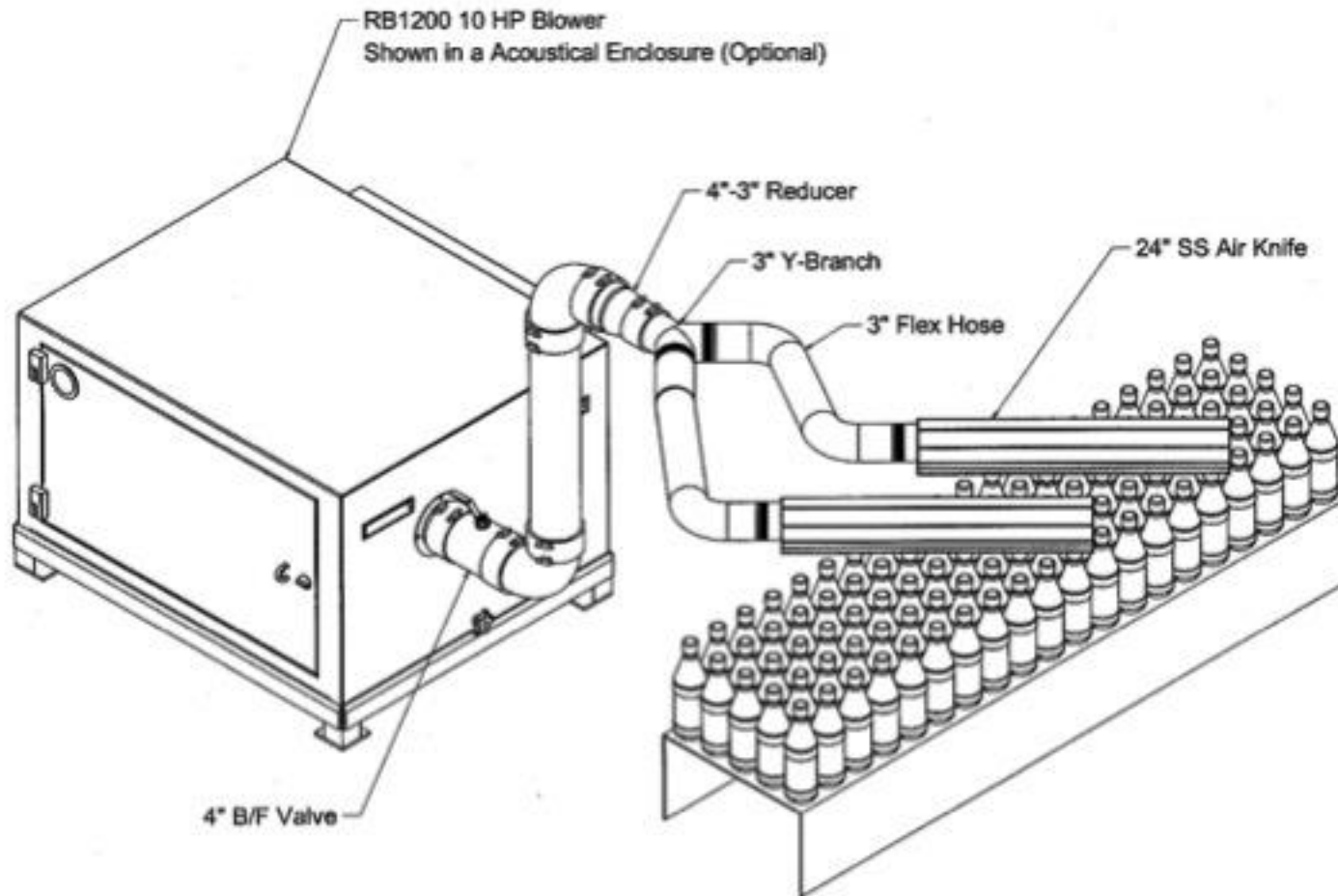

Warranty

Republic Blower Systems Warranty Terms and Conditions

Republic Sales and Manufacturing Company warrants all finished Republic Blower Systems products to be free from functional defects in material and workmanship for a period of twelve (12) months from the date of installation, or no longer than eighteen (18) months from shipment.

Wear parts such as drive belts, filter elements, hoses and pulleys are not covered by the 12/18-month warranty.

DISASSEMBLY OF BLOWER MAY VOID WARRANTY.

To obtain service within the warranty period, first contact your authorized Republic Sales and Manufacturing dealer or Republic Sales and Manufacturing Service Department. Republic's responsibility under this warranty shall be to provide an analysis of the blower, which will determine course of action. Any product found to be defective within the warranty period will merit either:

- a. A no charge repair of existing blower. Any freight charges will be the purchaser's responsibility.
- b. A replacement blower*. Any freight charges will be the purchaser's responsibility.

*This option would be chargeable replacement until the original blower is received by Republic Sales and Manufacturing, and warranty is approved.

Republic Sales and Manufacturing shall not be liable for incidental nor consequential damages resulting from the use of this product. There are no expressed nor implied warranties, which extend beyond the warranty of merchantability or fitness for a particular purpose to the equipment and/or its parts and components.