



Hockey Puck Elements

3 - 250 SCFM Flow Range

Features

- High grade filter element
- Element construction of injection molded thermoplastic
- Integrated gasket seal
 - Positive seal between housing hemispheres
 - New seal with each element
 - Minimizes parts
- Optimal surface area per given size
- Pleated media for high dirt holding capacity

Technical Specifications

- Temp (continuous): min -15°F (-26°C), max 220°F (104°C)
- Filter change out differential: 15-20" H₂O over initial Δ P
- Polyester: 99+% removal efficiency standard to 10 micron
- Paper: 99+% removal efficiency standard to 2 micron



Polyester Media Benefits/Specs

- Less maintenance due to longer durability
- Moisture resistant
- Handles hot air and oil mist from unload cycle of reciprocating/piston compressor
- Washable with lukewarm water and mild detergent (replacing element is recommended)

Paper Media Benefits/Specs

- Heavy duty industrial strength paper
- Cost effective
- Gently blow out media (replacing element is recommended)

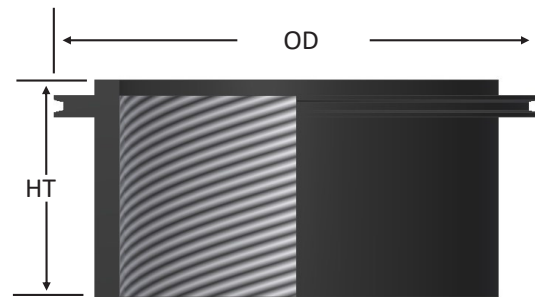

Element Part Number		Dimensions - inches		Surface Area ft ²	Element SCFM Rating
Polyester	Paper	O.D.	H.T.		
03	02	1 ½	1	0.1	3
05	04	2 ¼	1	0.2	8
07	06	3	1 ⅜	0.58	12
11	10	4	1 ⅜	1.1	35
17*	16	8	3 ¼	8	250

*Minimum order quantity applies.

See Element Technical Data for maintenance guidelines. Contact factory for options.

Rev: HPE-US1905K